



ARC 5

Open Ear AI Headphones

User Manual

Cleer ARC 5 Earbuds Model: GS1500E Charging Case Model: GS1519C

OWN THE MOMENT

Find this user manual on www.cleeraudio.com

Follow us on social media



GS1500-V2

Overview | Présentation | Descripción general

- 1 Touch screen
 - 2 Touch control area
 - 3 Physical button
 - 4 LED indicators
 - 5 Charging case reset button
- 1 Écran tactile
 - 2 Zone de commande tactile
 - 3 Bouton physique
 - 4 Témoins
 - 5 Bouton de réinitialisation du boîtier chargeur
- 1 Pantalla táctil
 - 2 Área de control táctil
 - 3 Botón físico
 - 4 Indicadores LED
 - 5 Botón de reinicio del estuche de carga

First-use | Première utilisation | Primer uso

For first-time use, open the charging case, tap and hold the reset button for 2 seconds, until the LED flashes red and white alternately in automatic pairing mode.

* When unboxing for the first time, please remove the protective film inside the charging case before use.

Pour la première utilisation, appuyez pendant 2 secondes sur le bouton multifonction pour l'allumer.

* Retirez le film protecteur lors du premier déballage.

Para utilizarlo por primera vez, mantenga pulsado el MFB durante 2s para encenderlo.

* Al desempaquetarlo por primera vez, retire la película protectora.

Proper Earbud Position
Position d'adaptation correcte
Posición de instalación correcta



Fitting | Mise en place | Instalación

Rotate the earhook hinge and slide the earhook behind your ear until it rests gently over the top of your ears.

Pivotez la charnière du crochet d'oreille puis faites glisser celui-ci derrière l'oreille jusqu'à ce qu'il épouse confortablement le contour de votre pavillon.

Gire la bisagra del arco auditivo y deslízalo por detrás de la oreja hasta que repose cómodamente sobre el pabellón auricular.



Power On / Off | Allumage / Éteindre | Encender / Apagar

- Open the charging case. The earbuds will power on automatically.
- Put earbuds in the charging case and close the lid. The earbuds will enter charging mode and disconnect.
- Without the charging case :
 - To power off manually : Press the physical button on either earbud once, until you hear "Power Off".
 - To power on manually : Press the physical button once on both earbuds separately, until you hear "Power On".

- Lorsque l'étui de charge est ouvert, les écouteurs s'allument automatiquement.
- Placez les écouteurs dans l'étui de charge et refermez le couvercle. Ils passeront automatiquement en mode charge et se déconnecteront.
- Sans étui de charge :
 - Extinction manuelle : Maintenez enfoncé une fois le bouton physique d'un écouteur jusqu'à l'annonce vocale « Power Off ».
 - Allumage manuel : Appuyez séparément une fois sur le bouton physique de chaque écouteur en maintenant jusqu'à l'annonce « Power On ».

- Al abrir el estuche de carga, los auriculares se encenderán automáticamente.
- Coloque los auriculares en el estuche de carga y cierre la tapa. Entrarán automáticamente en modo de carga y se desconectarán.
- Sin estuche de carga :
 - Apagado manual : Pulse y mantenga presionado el botón físico de cualquiera de los auriculares una vez hasta oír "Power Off".
 - Encendido manual : Pulse por separado una vez el botón físico en ambos auriculares manteniendo presionado hasta oír "Power On".

Bluetooth pairing | Appairage Bluetooth | Emparejamiento Bluetooth

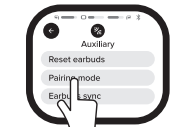
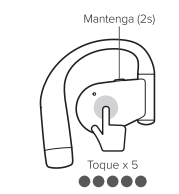
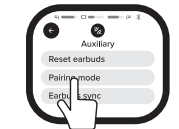
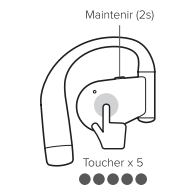
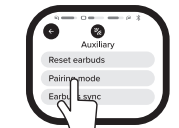
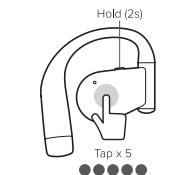

- For first-time use, open the charging case and remove the earbuds. The earbuds will automatically power on and enter pairing mode with LED blinking red and white alternately.

Or remove either earbud, press and hold the physical button for 2 seconds, or quickly tap the touch control area 5 times, until you hear "Looking for device".

Or put both earbuds in the case. Tap [Settings] → [Continue] → [Auxiliary] → [Pairing mode] on the screen. Remove the earbuds from the case, and they will automatically enter pairing mode.

- Select "Cleer ARC 5" in the pairing list on your mobile device.

* When you open the charging case for the first time, the earbuds will automatically enter pairing mode with LED blinking red and white alternately.

** Bluetooth disconnects when earbuds are stored in the charging case.

- Première utilisation: Ouvrez l'étui de charge et extrayez les écouteurs. Ils s'allumeront automatiquement et passeront en mode jumelage avec clignotement bicolore rouge/blanc alterné.

Retirez l'un des écouteurs, maintenez le bouton physique enfoncé pendant 2 secondes, ou effectuez 5 tap rapides sur la zone de contrôle tactile jusqu'à entendre "Looking for device".

Placez les deux écouteurs dans l'étui, puis appuyez sur [Paramètres] → [Continuer] → [Auxiliaire] → [Mode d'appairage] à l'écran. Lorsque vous retirez les écouteurs de l'étui, ils passent automatiquement en mode d'appairage.

- Choisissez « Cleer ARC 5 » pour vous connecter.

* Lors de la première ouverture de l'étui de chargement, les écouteurs entrent automatiquement en mode d'appairage avec clignotement alternatif rouge et blanc des LED.

** La connexion Bluetooth se désactive lorsque les écouteurs sont rangés dans l'étui.

- Uso inicial: Abra el estuche de carga y retire los auriculares. Se encenderán automáticamente ingresando a modo emparejamiento con LED intermitente rojo/blanco alternante.

Retire cualquiera de los auriculares, mantenga presionado el botón físico durante 2 segundos, o toque rápidamente 5 veces el área de control táctil hasta escuchar "Looking for device".

Coloque ambos auriculares en el estuche, pulse en la pantalla [Ajustes] → [Continuar] → [Auxiliar] → [Modo de emparejamiento]. Al retirar los auriculares del estuche, entrarán automáticamente en modo de emparejamiento.

- Elija "Cleer ARC 5" para conectarse.

* Al abrir el estuche de carga por primera vez, los auriculares entrarán automáticamente en modo de emparejamiento con LED parpadeando alternativamente en rojo y blanco.

** La conexión Bluetooth se desconecta cuando los auriculares se guardan en el estuche.

Cleer+ App | Application Cleer+ | Cleer+ App

Get more control and personalized listening experience with this free App.

Obtenez encore plus de contrôle et de personnalisation de votre expérience d'écoute avec cette application gratuite.

Consiga aún más control y personalización de su experiencia auditiva con esta app gratuita.



UV Sterilization | Stérilisation aux UV-C | Esterilización con luz UV-C

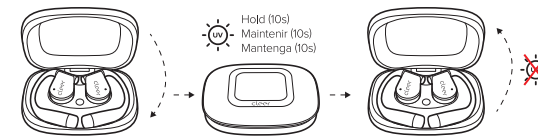

* Data provided by a certified third-party testing organization. All data was obtained under laboratory conditions and is for reference only. UV sterilization can effectively eliminate 99.9% or more of harmful bacteria and viruses on the corresponding earbud surfaces, including Staphylococcus aureus, Escherichia coli, Candida albicans, Pseudomonas aeruginosa, H1N1 influenza virus, and norovirus.

* Les données proviennent d'institutions de test tierces autorisées. Toutes les données sont obtenues en laboratoire et sont fournies à titre indicatif. La stérilisation peut tuer efficacement 99,9 % ou plus de bactéries nocives telles que Staphylococcus aureus, Escherichia coli, Candida albicans, Salmonella, Klebsiella pneumoniae et Pseudomonas aeruginosa à l'endroit correspondant sur les écouteurs.

* Los datos proceden de instituciones de ensayo autorizadas de terceros. Todos los datos se obtienen en el laboratorio y son sólo de referencia. La esterilización puede eliminar eficazmente el 99,9% o más de bacterias nocivas como Staphylococcus aureus, Escherichia coli, Candida albicans, Salmonella, Klebsiella pneumoniae y Pseudomonas aeruginosa en la zona correspondiente de los auriculares.



This feature is disabled by default. You can enable or disable it on demand using the following methods:

Cette fonction est désactivée par défaut. Vous pouvez rapidement activer ou désactiver la fonction de la manière suivante, selon vos besoins:

Esta función está desactivada por defecto. Puede activarla o desactivarla rápidamente en función de sus necesidades de las siguientes formas:

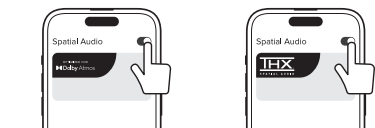

A : Operate on the homepage of the Cleer+ App
A : Action dans la page d'accueil de l'application Cleer+
A : Use la página de inicio de la aplicación Cleer+

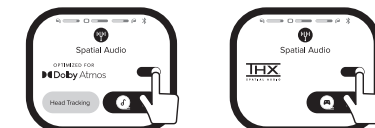

B : Operate on the Dolby and THX interface of the charging case touch screen
B : Opérez sur l'interface Dolby et THX de l'écran tactile de l'étui de charge
B : Opere la interfaz Dolby y THX en la pantalla táctil del estuche de carga



C : Customize quick sound effect shortcuts on the Touch Controls interface of the Cleer+ App
C : Personnalisez les raccourcis d'effets sonores rapides dans l'interface Touch Controls de l'application Cleer+
C : Personalice accesos directos de efectos sonoros rápidos en la interfaz de Controles Táctiles de la aplicación Cleer+

Voice Control

* Disabled by default. Turn it on in the Cleer+ App.



When using the earbuds, simply say the following statements to control the earbuds.

- Previous song / Next song
- Play music / Pause music
- Volume up / Volume down
- Take a photo

Head Motion Control (Music / Call) | Commandes par mouvements de la tête (Appel) | Control de movimiento de la cabeza (Llamada)

* Disabled by default. Turn it on in the Cleer+ App. Cette fonction est désactivée par défaut. Activez-la dans l'application Cleer+. Esta función está desactivada por defecto. Actívala en Cleer+ App.

- Nod x2 / Hochement de tête x2 / Asentir x2
Call : Pick up / Appel : décrocher / Llamada : Contestar
- Shake head x2 / Secouer la tête x2 / Sacudir la cabeza x2
Call : Hang up / Rejet / Appel : raccrocher / Rejeter / Llamada : Colgar / Rechazar
- Turn head to the left and then turn back / Tourner la tête vers la gauche puis revenir en arrière / Girar la cabeza a la izquierda y luego volver
Music : Previous track / Musique : Piste précédente / Música : Pista anterior
- Turn head to the right and then turn back / Tourner la tête vers la droite puis revenir en arrière / Girar la cabeza a la derecha y luego volver
Music : Next track / Musique : Piste suivante / Música : Siguiente pista

Touch Control (Music / Call) | Commandes des écouteurs (Musique / Appel) | Control de auriculares (Música / Llamada)

* You can customize music touch controls in the Cleer+ App. Vous pouvez personnaliser vous-même les touches de l'application Cleer+. Puede personalizar el toque en Cleer+ App por sí mismo.

- Tap x1 / Toucher x1 / Toque x1
Music : Play / Pause / Musique : Lecture / Pause / Música : Reproducir / Pausar
- Tap x2 / Toucher x2 / Toque x2
Music : Next track / Musique : Piste suivante / Música : Siguiente pista
Call : Pick up / hang up call / Appel : décrocher / raccrocher / Llamada : Contestar / Colgar llamada
- Tap x3 / Toucher x3 / Toque x3
Music : Previous track / Musique : Piste précédente / Música : Pista anterior
- Tap and Hold / Maintenir / Mantenga
Call : Reject call / Appeler : Rejeter l'appel / Llamada : Rechazar llamada

Touch Control (Volume) | Commandes des écouteurs (Volume) | Control de auriculares (Volumen)

* This feature is unavailable when using one earbud. Cette fonction n'est pas disponible lors de l'utilisation d'un seul écouteur. Esta función no está disponible al utilizar un solo auricular.

- Right earbud | Écouteur droit | Auricular derecho
Tap x2 + Hold / Toucher x2 + Maintenir / Toque x2 + Mantenga
Volume up continuously / Augmentation continue du volume / Subir el volumen continuamente
- Left earbud | Écouteur gauche | Auricular izquierdo
Tap x2 + Hold / Toucher x2 + Maintenir / Toque x2 + Mantenga
Volume down continuously / Baisser le volume en continu / Bajar el volumen continuamente

LED Behavior | Comportement des témoins |

Funcionamiento de LED

	Not connected to any device Pas de connexion à un appareil No conectado a ningún dispositivo
	Connected to a device Connecté à un appareil Conectado a un dispositivo
	Pairing Appairage Modo de emparejamiento
	Battery below 10% Batterie inférieure à 10% Bateria por debajo del 10%
	Charging Charge Cargando
	Fully charged Charge complète Completamente cargada

LED OFF
TÉMOIN ÉTEINT
LED APAGADO

Charging | Charge | Cargando



Use the included USB-C charging cable to charge.
Chargez avec le câble USB-C fourni.
Cargue con el cable USB-C incluido.

Earbuds Sync Mode | Appairage des écouteurs | Modo de emparejamiento de los auriculares

If one earbud is lost, place both the new and original earbuds in the case. Tap [Settings] → [Continue] → [Auxiliary] → [Earbuds Sync] on the touch screen to complete the synchronization process. Now, both the new and original earbuds are paired together.



Placer l'écouteur de remplacement et l'unité existante dans l'étui → Appuyer sur [Paramètres] → [Continuer] → [Auxiliaire] → [Synchronisation écouteurs] sur l'écran tactile pour finaliser l'appariement.

Coloque tanto la unidad nueva como el auricular original en el estuche → Pulse [Ajustes] → [Continuar] → [Auxiliar] → [Sincronización de auriculares] en la pantalla táctil para completar el emparejamiento.

Restore Factory Settings | Restauration des réglages d'usine | Restaurar la configuración de fábrica



Restore Earbuds to Factory Settings
Reset with App: Connect ARC 5 to Cleer+ App. Tap [Settings] → [Restore factory setting] in the app and complete the process.



Reset with touch screen: Put both earbuds in the case. Tap [Settings] → [Continue] → [Auxiliary] → [Reset earbuds] on the screen and complete the process.

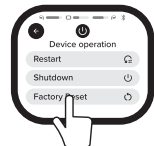

Restore Charging Case to Factory Settings
Reset with touch screen: Put both earbuds in the case. Tap [Settings] → [Continue] → [Device operation] → [Factory reset] on the screen and complete the process.



Restauration des paramètres d'usine
Réinitialisation par application: Connectez ARC 5 à l'application Cleer+. Appuyez sur [Paramètres] → [Restaurer les paramètres d'usine] et terminez le processus.



Réinitialisation par écran tactile: Placez les écouteurs dans l'étui → Appuyez sur [Paramètres] → [Continuer] → [Auxiliaire] → [Réinitialiser les écouteurs] sur l'écran et terminez le processus.



Restauration des paramètres d'usine du boîtier chargeur
Réinitialisation tactile: Placer les deux écouteurs dans l'étui Toucher Tap [Settings] → [Continue] → [Device operation] → [Factory Reset] sur l'écran pour finaliser.



Restablecimiento de configuración de fábrica
Reset por aplicación: Conecte ARC 5 a la aplicación Cleer+. Pulse [Ajustes] → [Restablecer valores de fábrica] y complete el proceso.



Reset por pantalla táctil: Coloque los auriculares en el estuche → Pulse [Ajustes] → [Continuar] → [Auxiliar] → [Restablecer auriculares] en pantalla y complete el proceso.



Restaurar el estuche de carga a la configuración de fábrica
Restablecimiento táctil: Coloque ambos auriculares en estuche Pulse [Settings] → [Continue] → [Device operation] → [Factory Reset] en pantalla para completar.

Specifications | Spécifications | Especificaciones

Driver:	16.2mm neodymium dynamic driver
Audio CODEC support:	aptX™ Lossless, aptX™ Adaptive, LDAC, AAC, SBC
Frequency response range:	65 Hz - 40 kHz
Connections:	USB-C cable for charging, charging current 5V/2A
UVC:	UVC 270 ± 10nm
Battery capacity:	Earbuds battery: 3.85V 100mAh 0.385Wh Charging case battery: 3.85V 1250mAh 4.813Wh
Battery charging:	Earbuds: A 5-minute charge will give 2 hours of playtime and can be fully charged in 1 hour. Charging case: Less than 2.5 hours for a full charge.
Playback time:	Up to 12 hours*. Charging case provides an extra 48 hours of use.
Support:	Bluetooth 5.4, A2DP v1.4, AVRCP v1.6.2, HFP v1.9
Weight:	11.5g (per earbud), 117g (earbuds and case)

* Data comes from Cleer Lab. The playtime is tested by AAC-encoded audio at 75% volume on Apple mobile device. Specific battery life will vary depending on the volume, connected device and usage habits. Please refer to your mobile device when you use them.

Haut-parleur:	haut-parleur dynamique en néodyme de 16,2 mm
Prise en charge de CODEC audio:	aptX™ Lossless, aptX™ Adaptive, LDAC, AAC, SBC
Réponse en fréquence:	65 Hz - 40 kHz
Connexions:	câble USB-C pour la charge, courant de charge 5V/2A
UVC:	UVC 270 ± 10nm
Capacité des batteries:	Écouteurs: 3.85V 100mAh 0.385Wh Étui de charge: 3.85V 1250mAh 4.813Wh
Charge de la batterie:	Écouteurs: Une charge de 5 minutes donne une autonomie de 2 heures, et la charge complète s'effectue en 1 heure. Étui de charge: Moins de 2,5 heures pour une charge complète.
Autonomie de lecture:	jusqu'à 12 heures*, au total 48 heures avec le boîtier chargeur.
Prise en charge:	Bluetooth 5.4, A2DP v1.4, AVRCP v1.6.2, HFP v1.9
Poids:	11,5g (par écouteur), 117g (les deux écouteurs et le boîtier)

* Les données proviennent de Cleer Lab. L'autonomie est testée avec un son encodé AAC à 75% du volume sur un appareil mobile Apple. L'autonomie de la batterie varie en fonction du volume, de l'appareil connecté et des habitudes d'utilisation. Veuillez vous référer à votre appareil mobile lorsque vous les utilisez.

Transductor:	transductor dinámico de neodimio de 16,2mm
Compatibilidad con códigos de audio:	aptX™ Lossless, aptX™ Adaptive, LDAC, AAC, SBC
Rango de respuesta en frecuencia:	65 Hz - 40 kHz
Conexiones:	Cable USB-C para carga, Corriente de carga 5V/2A
UVC:	UVC 270 ± 10nm
Capacidad de batería:	Auriculares: 3.85V 100mAh 0.385Wh Estuche: 3.85V 1250mAh 4.813Wh
Carga de la batería:	Auriculares: una carga de 5 minutos ofrecerá 2 horas de reproducción, y la carga completa se realiza en 1 hora. Estuche de carga: Menos de 2,5 horas para una carga completa.
Tiempo de reproducción:	Hasta 12 horas*, en total 48 horas con estuche de carga.
Soporte:	Bluetooth 5.4, A2DP v1.4, AVRCP v1.6.2, HFP v1.9
Peso:	11,5g (por auricular), 117g (ambos auriculares y estuche)

* Los datos proceden de Cleer Lab. El tiempo de reproducción se comprueba con audio codificado en AAC al 75% de volumen en un dispositivo móvil Apple. La duración específica de la batería variará en función del volumen, el dispositivo conectado y los hábitos de uso. Por favor, consulte su dispositivo móvil cuando los utilice.

Tips

1. How to set up your iPhone to answer calls with Bluetooth earbuds: [Settings] → [Accessibility] → [Touch] → [Call Audio Routing] → [Bluetooth Headset]

2. Volume sync setting
a. The volume levels between iPhones and earbuds are automatically synchronized.
b. Volume levels between certain Android phones and earbuds may become unsynchronized. Adjusting the phone's volume might not alter the earbuds' volume accordingly. For detailed setup instructions, please contact the phone manufacturer's support.



Samsung setting reference

Quick Troubleshooting

- Low volume issue: Typically caused by unsynchronized volume levels between the earbuds and phone. Please refer to the "Volume sync setting" method above.
- Earbuds don't charge in the charging case: first make sure the charging case is charged. Then check the charging contacts of the earbuds and the charging case respectively, and use soft cloth to clean up the dirt on the contacts and then try again.
- Earbuds are hot when charging: when charging earbuds in charging case, especially the earbuds with 0% battery level, it is normal to be slightly hot for the earbuds during fast charging. After taking the earbuds out of the charging case, the temperature of earbuds will return to normal. But when the earbuds become extremely hot, take them out of the charging case immediately and contact the after-sales service for further processing.
- Touch screen of charging case does not respond: open the charging case, tap and hold the charging case reset button for 8 seconds and the charging case will be reset.

Maintenance

- If the earbuds are exposed to dust, sweat, ink, oil, pollen, or chemicals (such as soap, hand sanitizer, shampoo, shower gel, laundry detergent, detergent, cosmetics, anti-UV products, antibacterial spray, high-concentration alcohol, insecticide, and mosquito repellent) and other substances that may cause damage to the earbuds, please dampen a piece of cloth slightly with water and wipe the earbuds. Then, wipe them with a piece of dry, soft lint-free cloth and dry them in the air.
- Do not use any chemicals or organic solvents (such as soapy water, hand sanitizer or other acid-base solvents) to clean the earbuds, or the residual may cause skin irritation.
- Please regularly use a soft, lint-free cloth to wipe the earbuds. Do not use paper towels or cloth containing wood fibers.
- When you put the earbuds back into the charging case for charging, please make sure that the earbuds are dry and clean.
- When charging of the earbuds fails, please check whether the charging contacts of the charging case and earbuds are dirty. If yes, please wipe them clean with a piece of cloth or cotton swab, then try again.
- Please use and store the product and its accessories within the temperature range of 5°C to 35°C. Operating the device in temperatures that are too high or too low may cause malfunctions. When the temperature drops below 5°C, battery performance may deteriorate.

Skin Irritation Notice

- A small number of users may experience skin reactions due to certain materials, specially when exposed to specific environments or prolonged contact with potential irritants such as soap, sweat, sunscreen, or lotion.

- To minimize the risk of skin irritation, avoid wearing the product on areas of broken or injured skin.
- Keeping your earbuds clean and dry can help reduce the chance of irritation.
- Remember to take off your earbuds regularly to let your skin breathe and your ears relax.
- If you have sensitive skin, it is recommended not wearing the earbuds for more than 3 hours at a time.
- If you notice redness, swelling, itching, or any other signs of skin irritation, stop using the product immediately and consult a doctor.

Warranty

Cleer Limited Warranty

Cleer Limited warrants this product against defects in material or workmanship for (1) year as set forth below when purchased directly from Cleer Limited or a Cleer Limited authorized retailer. Pursuant to this Limited Warranty, Cleer Limited will, at its option, (i) repair the product using new or refurbished parts or (ii) replace the product with a new or refurbished product. For purposes of this Limited Warranty, "refurbished" means a product or part that has been returned to its original specifications. In the event of a defect, these are your exclusive remedies.

Labor: For a period of (1) year from the original date of purchase of the product ("Labor Warranty"), Cleer Limited will, at its option, repair or replace with new or refurbished product, product determined to be defective. If Cleer Limited elects to replace the product after this Labor Warranty has expired but while the parts warranty is still in effect, it will do so for the applicable labor charge.

Parts: For a period of (1) year from the original date of purchase of the product ("Parts Warranty"), Cleer Limited will supply new or refurbished replacement parts in exchange for parts determined to be defective.

This Limited Warranty covers only the hardware components packaged with the Product. It does not cover technical assistance for hardware or software usage and it does not cover any software products whether or not contained in the Product; any such software is provided "AS IS" unless expressly provided for in any enclosed software Limited Warranty. Please refer to the End User License Agreements included with the Product for your rights and obligations with respect to the software.

Instructions: To obtain warranty service, you must deliver the Product, freight prepaid, in either its original packaging or packaging affording an equal degree of protection to the original Cleer Limited retailer (point of purchase) or Cleer Limited Customer Service. It is your responsibility to backup any data, software or other materials you may have stored or preserved on your unit. It is unlikely that such data, software or other materials will be lost or reformatted during service and Cleer Limited will not be responsible for any such damage or loss. A dated purchase receipt from Cleer Limited or a Cleer Limited retailer is required. For specific instructions on how to obtain warranty service for your product, visit the Cleer Limited website: www.cleeraudio.com

Following warranty service your original Product or a replacement Product will be returned to you as your Product was configured when originally purchased.

Repair / Replacement Warranty: This Limited Warranty shall apply to any repair, replacement part or replacement product for the remainder of the original Limited Warranty period or for (90) days, whichever is longer. Any parts or product replaced under this Limited Warranty will become property of Cleer Limited.

This Limited Warranty shall not apply to: (a) consumable parts, such as batteries that are designed to diminish over time, unless failure has occurred due to a defect in materials or workmanship; (b) cosmetic damage, including but not limited to scratches, dents and broken plastic on ports; (c) defects caused by normal wear and tear or otherwise due to the normal aging of the device; (d) damage caused by accident, negligence, abuse, misuse, fire, earthquakes, acts of God or damage resulting from liquid outside of the approved levels; (e) damage caused by operating the device outside Cleer Limited published guidelines; (f) damage caused by service performed by anyone who is not a representative of Cleer Limited or a Cleer Limited authorized service provider; (g) Products whose seals are tampered; (h) Products whose serial numbers have been removed or defaced from such Product; (i) modifications, alterations or repairs to the Product made by a party other than Cleer Limited or a party authorized by Cleer Limited; (j) any failure by End User or a third party to comply with environmental and storage requirements for the Product specified by Cleer Limited, including, without limitation, temperature or humidity ranges; or (k) use of the Product in combination with any third-party devices or products that have not been provided or recommended by Cleer Limited.

LIMITATION ON DAMAGES: CLEER LIMITED SHALL NOT BE LIABLE FOR ANY INCIDENTAL OR CONSEQUENTIAL DAMAGES FOR BREACH OF ANY EXPRESS OR IMPLIED WARRANTY ON THIS PRODUCT.

DURATION OF IMPLIED WARRANTIES: EXCEPT TO THE EXTENT PROHIBITED BY APPLICABLE LAW, ANY IMPLIED WARRANTY OF MERCHANTABILITY OR FITNESS FOR A PARTICULAR PURPOSE ON THIS PRODUCT IS LIMITED TO THE DURATION OF THIS WARRANTY.

DISCLAIMER: THE LIMITED WARRANTY SET FORTH HEREIN IS EXCLUSIVE AND IN LIEU OF ALL OTHER WARRANTIES OR CONDITIONS RELATING TO THE PRODUCT, WHETHER EXPRESS OR IMPLIED, AND CLEER LIMITED EXPRESSLY DISCLAIMS ALL OTHER WARRANTIES AND CONDITIONS WHETHER EXPRESS, IMPLIED OR STATUTORY, INCLUDING ANY IMPLIED WARRANTIES OF MERCHANTABILITY, NON-INFRINGEMENT, FITNESS FOR A PARTICULAR PURPOSE, AND ANY WARRANTIES ARISING OUT OF COURSE OF DEALING OR USAGE OF TRADE AND AGAINST HIDDEN DEFECTS, TO THE FULLEST EXTENT PERMITTED BY LAW. CLEER LIMITED DOES NOT WARRANT THAT THE PRODUCT WILL MEET CUSTOMER'S REQUIREMENTS OR THAT USE OF THE PRODUCT WILL BE UNINTERRUPTED OR ERROR FREE. NO ADVICE OR INFORMATION, WHETHER ORAL OR WRITTEN, OBTAINED FROM CLEER LIMITED OR ELSEWHERE WILL CREATE ANY WARRANTY NOT EXPRESSLY STATED IN THIS WARRANTY.

Notice

Recycling



Your product is designed and manufactured with high quality materials and components, which can be recycled and reused. When you see the crossed out wheel bin symbol attached to a product, it means the product is covered by the European Directive 2002/96 EC:



Never dispose of your product with other household waste. Please inform yourself about the local rules on the separate collection of electrical and electronic products. The correct disposal of your old product helps prevent potentially negative consequences on the environment and human health. Your product contains batteries covered by the European Directive 2006/66/EC, which cannot be disposed of with normal household waste.

The device complies with RF specifications when the device used at 0mm from your body. Hereby, Cleer Limited. Declares that the product compliance with essential requirements and other relevant provisions of Directive 2014/53/EU.

The device contains licence-exempt transmitter(s)/receiver(s) that comply with Innovation, Science and Economic Development Canada's licence-exempt RSS(s). Operation is subject to the following two conditions:
(1) This device may not cause interference.
(2) This device must accept any interference, including interference that may cause undesired operation of the device.

L'émetteur/récepteur exempt de licence contenu dans le présent appareil est conforme aux CNR d'Innovation, Sciences et Développement économique Canada applicables aux appareils radio exempts de licence. L'exploitation est autorisée aux deux conditions suivantes :

- L'appareil ne doit pas produire de brouillage;
- L'appareil doit accepter tout brouillage radioélectrique subi, même si le brouillage est susceptible d'en compromettre le fonctionnement.

RF Exposure Statement:

The device is compliance with RF exposure guidelines, users can obtain Canadian information on RF exposure and compliance. The device can be used in portable exposure condition without restriction.

Le présent appareil est conforme Après examen de ce matériel aux conformités ou aux limites d'intensité de champ RF, les utilisateurs peuvent sur l'exposition aux radiofréquences et compliance d'acquies les informations correspondantes. L'appareil peut être utilisé dans des conditions d'exposition portatives sans restriction.

FCC STATEMENT :

This device complies with Part 15 of the FCC Rules. Operation is subject to the following two conditions:

- (1) This device may not cause harmful interference, and
- (2) This device must accept any interference received, including interference that may cause undesired operation.

Warning: Changes or modifications not expressly approved by the party responsible for compliance could void the user's authority to operate the equipment.
This Class B digital apparatus complies with Canadian ICES-003.
Cet appareil numérique de la classe B est conforme à la norme NMB-003 du Canada.

NOTE: This equipment has been tested and found to comply with the limits for a Class B digital device, pursuant to Part 15 of the FCC Rules. These limits are designed to provide reasonable protection against harmful interference in a residential installation. This equipment generates uses and can radiate radio frequency energy and, if not installed and used in accordance with the instructions, may cause harmful interference to radio communications. However, there is no guarantee that interference will not occur in a particular installation. If this equipment does cause harmful interference to radio or television reception, which can be determined by turning the equipment off and on, the user is encouraged to try to correct the interference by one or more of the following measures: Reorient or relocate the receiving antenna. Increase the separation between the equipment and receiver. Connect the equipment into an outlet on a circuit different from that to which the receiver is connected. Consult the dealer or an experienced radio/TV technician for help.

RF warning statement:

The device has been evaluated to meet general RF exposure requirement. The device can be used in portable exposure condition without restriction.

Register your product and get support at www.cleeraudio.com

©2025 Cleer Limited. All rights reserved.

The Bluetooth® word mark and logos are registered trademarks owned by Bluetooth SIG, Inc. and any use of such marks by Cleer Limited is under license. Other trademarks and trade names are those of their respective owners.

Dolby, Dolby Audio, Dolby Atmos, and the double-D symbol are trademarks of Dolby Laboratories Licensing Corporation. Manufactured under license from Dolby Laboratories. Confidential unpublished works. Copyright © 1992–2025 Dolby Laboratories. All rights reserved.

THX and the THX Logo are the property of THX Ltd., registered in the U.S. and other countries.

Qualcomm aptX is a product of Qualcomm Technologies International, Ltd. Qualcomm is a trademark of Qualcomm Incorporated, registered in the United States and other countries, used with permission. aptX is a trademark of Qualcomm Technologies International, Ltd., registered in the United States and other countries, used with permission.

Made in China.

